

Technical data sheet for

PW1

High Performance Potwasher

W 680mm x D 765mm x H 1850mm



The front loading PW1 washes pots, bins, trays and most bowls up to 80 litres and also has a rail for hanging whisks, ladles and other utensils.

Standard Features

- Large 1.5kW wash pump recirculates wash water at nominal 800 litres per minute for superior cleaning of heavily soiled items
- Triple cycle selection - 2, 4, and 6 minute cycles
- Powerful rinse booster elements ensure fast recovery between cycles
- 750 mm high wash chamber clearance for tall or long items including bakery trays
- Large internal chamber with usable area 565 x 595mm
- Hanging rail for whisks, ladles etc
- 2.6 litres per cycle water consumption
- Upper and lower stainless steel arms with removable end caps for cleaning
- Stainless steel support grid for bowls etc.
- FastClean - rounded wash tank, double filtration, scrap and pump inlet filters
- Robust stainless steel construction
- Electromechanical controls
- Counterbalanced insulated two piece door with safety stop switch
- 220mm stainless steel legs for access beneath machines
- Suits 500mm international racks
- Rinse booster pump for optimal rinse quality
- Integral precision detergent dispensing pump
- Backflow prevention fitted
- Wash chamber

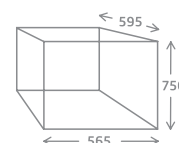
**Accessories**

- 1 x 500mm Dish Rack
- 1 x 500mm Cup Rack
- 1 x 8 Division Cutlery Container
- 1 x 435mm Cup Cover

Options

- Customised loading racks
- Complete wash stations
- Fisher prerinse and tapware



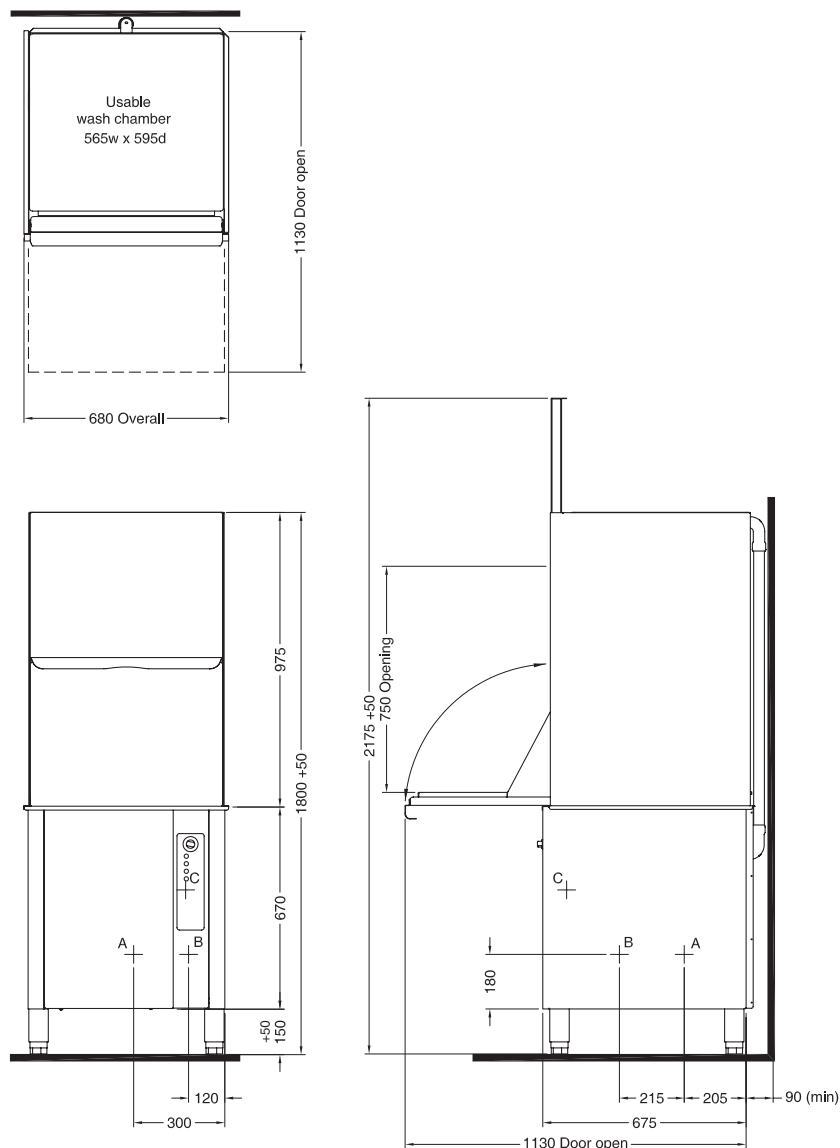

A	Hot Water	temperature connection pressure flow quality backflow prevention	65C 1/2" 200-350 kPa 20 litres per min potable & soft atmospheric vacuum breaker
B	Waste	connection line	1.5 BSP 2" BSP
C	Electrical	3 phase N+E 400V 50Hz	15A/phase, 9kW

Refer operator manual for complete installation instructions.

Dimensions

Width	680mm
Depth	765mm
Height	1850mm
Weight	125kg

Packed Dimensions

Width	850mm
Depth	850mm
Height	1790mm
Weight	165kg
Cubic metres	1.29m³

STARLINE®
PROFESSIONAL WASH SYSTEMS

Designed and manufactured by
WASHTECH®

ISO9001

All Washtech products are designed and manufactured by Washtech using the internationally recognised ISO9001 quality management system, covering design, manufacture and final inspection, ensuring consistent high quality at all times.

In line with policy to continually develop and improve its products, Washtech reserves the right to change specifications and design without notice.



On call service where you are.

Washtech provides full service backup, 24 hours a day, 7 days a week with factory based technicians and a comprehensive nationwide network of independent service providers.

STARLINE SERVICE 09 829 0923

WASHTECH LTD

PO Box 90-548
Auckland 1142

414 Rosebank Road
Avondale
Auckland 1026
New Zealand

Phone 09 829 0930
info@washtech.co.nz
www.starline.co.nz

© Copyright Washtech 2011